

PS-3416/3416E
Fanless LCD Touch Terminal
User Manual



Package Contents

- ✓ Fanless LCD touch terminal (x1)
- ✓ Power adaptor (x1)
- ✓ Power cord (x1)
- ✓ User Manual (x1)
- ✓ Recovery DVD (x1)
(for pre-loaded OS model only)

This system meets industry & government requirements and applicable standards.

✘ **The appearance of the product may be somewhat different from that of the actual product, so the appearance of this product should be based on that of physical products. The contents in this manual may be updated at any time without prior notice.**

This equipment generates, uses, and can radiate radio frequency energy and, if not installed and used in accordance with the instructions manual, may cause interference to radio communications. It has been tested and found to comply with limits for a Class A digital device pursuant to subpart J of Part 15 of FCC Rules, which are designed to provide reasonable protection against interference when operated in a commercial environment. Operation of this equipment in a residential area is likely to cause interference in which case the user at his own expense will be required to take whatever measures to correct the interference.



This is a class A product. In a domestic environment this product may cause radio interference in which case the user may be required to take adequate measures.

CAUTION
RISK OF EXPLOSION IF BATTERY IS REPLACED
BY AN INCORRECT TYPE
DISPOSE OF USED BATTERIES ACCORDING
TO THE INSTRUCTIONS

13120901020 Ver. B0
<http://www.posiflex.com>

Terminal from shipping mode to operation mode

In consideration of proper packaging, before shipping, the terminal is folded, staying in shipping mode. Thus, when receiving the product, you will find that the terminal is well folded, as shown below.



Before operating this terminal, unfold it and make this terminal rise in operation mode by referring to the following steps. Here, an equivalent model with GEN 7 base is taken below for example.

1. Firstly, lift this terminal gently to make it to be unfolded.



2. Overturn this terminal in the direction as indicated by the arrow in the right figure.



3. Place this terminal on a flat table.



4. Tilt this terminal to a degree in the direction as indicated by the arrow below.

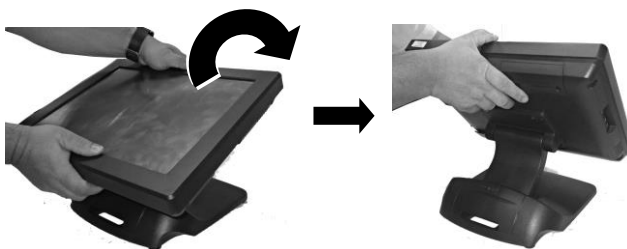

Terminal from operation mode to shipping mode

To fold this terminal, refer to the following steps. Here, an equivalent model with GEN 7 base is taken below for example.

1. Remove the cable cover.



2. Carefully hold the lower rim of the display.



3. Push the base-folding lever in the direction as indicated by the arrow below (1). Then, the display will be loosen and go down (2).

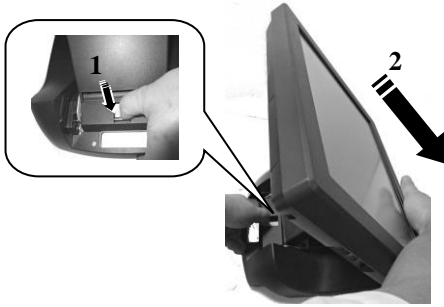

4. When the display goes down to a degree, loose the base-folding lever, as shown in the direction as indicated by the arrow below.

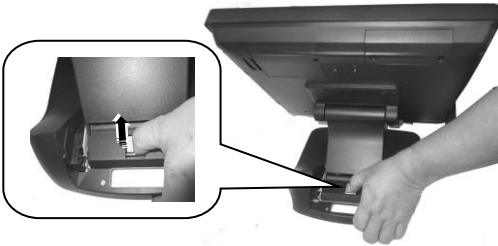

5. Then, gently tilt the display in the direction as indicated by the arrow below until the display is well folded.

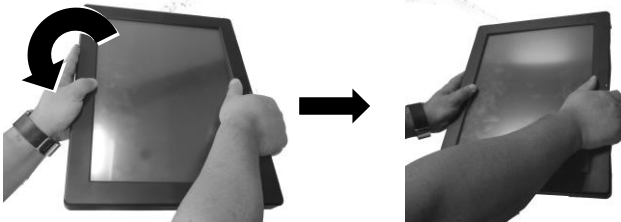

6. Put back the cable cover.

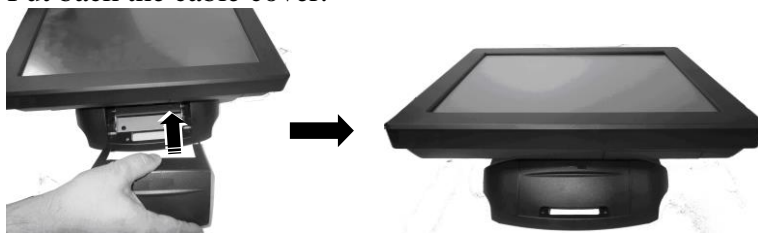

Views of the PS-3416/3416E

Front View

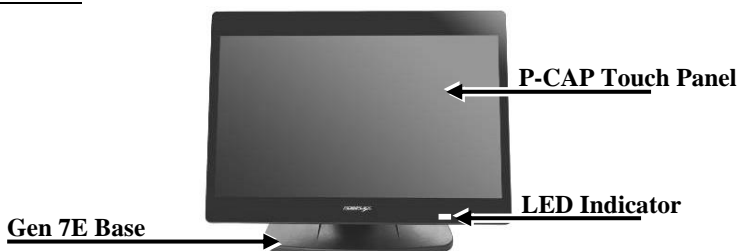

Rear View

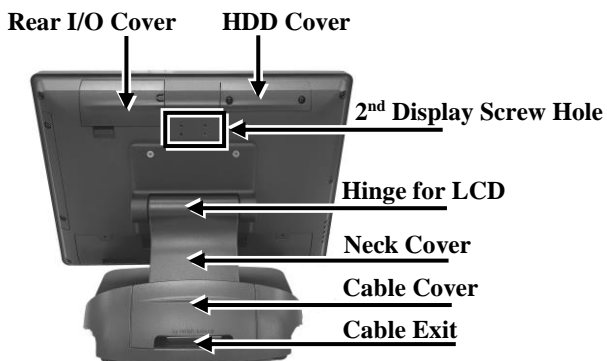

Left Side View



Right Side View

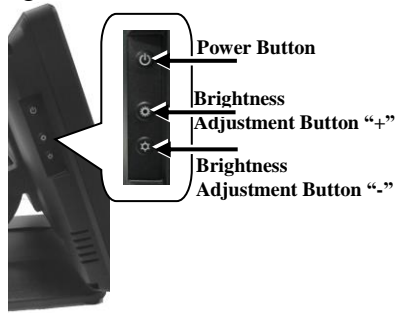

Bottom View

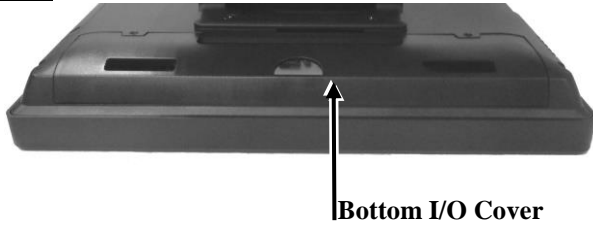

View of I/O Interface

Top I/O Ports

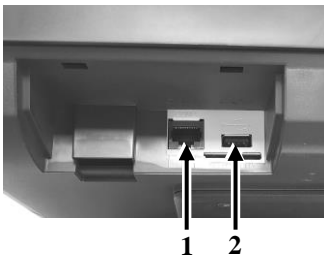

- 1 COM4 Port
- 2 USB 2.0 Port

Rear I/O Ports

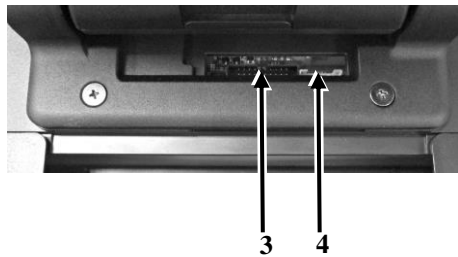

- 3 Parallel (LPT) Port Connector
- 4 PS/2_Keyboard Pin Header

※ The top I/O ports are provided for COM-based and USB-based peripheral devices, for example, customer display.

Bottom I/O Ports

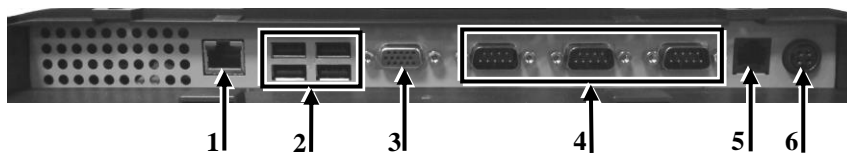

- | | | | |
|---|-----------------------|---|------------------------------|
| 1 | RJ45 LAN Port | 2 | USB 2.0 Port |
| 3 | VGA Port | 4 | COM Port
(COM3/COM2/COM1) |
| 5 | RJ11 Cash Drawer Port | 6 | 12VDC-IN Power Jack |

Installing Optional Upgrade Kits and Peripherals

PS-3416/3416E can work with multiple optional upgrade kits and peripheral devices, such as magnetic stripe reader (MSR), LCD monitor, cash drawer and the like.

Before installing an optional upgrade kit and/or peripheral device, make sure that the system is powered off and the external power source is removed from the POS box to prevent electric hazard! Failure to follow the warning description will void the product warranty!

For the detailed instruction, refer to each of the user manuals of the optional upgrade kits and peripheral devices.

Connecting Power Adapter and I/O Cables

Before connecting power adapter and I/O cables to the I/O ports of PS series terminal, please route and arranging the cables. Refer to the following step-by-step instruction of cable routing and arrangement for the details. Here, an equivalent model with GEN 7 base is taken below for example.

1. Press the circled section of the cable cover with your thumb.

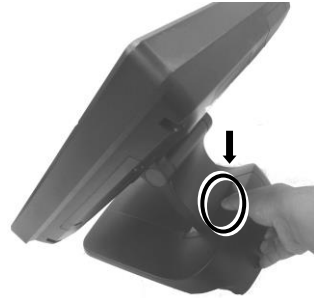

2. Pull out the cable cover.

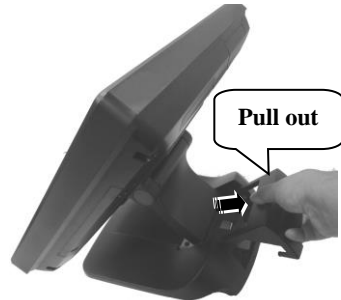

3. Push and tilt the terminal to the end in the direction as shown by the arrow.



4. Determine that the terminal is tilted to the end, as shown in the right figure.



5. Press the circled section with two thumbs and pull by force the two sides of the locking hook with two forefingers as indicated by the arrow.

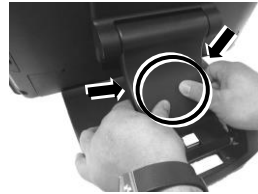

6. Remove the neck cover from the base stand.

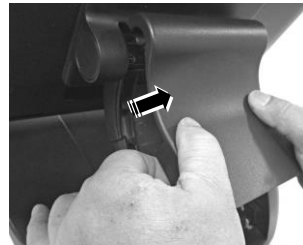

7. Tilt the terminal slightly at a little angle in the direction as shown by the arrow, making cables easily pass through the cable passage.

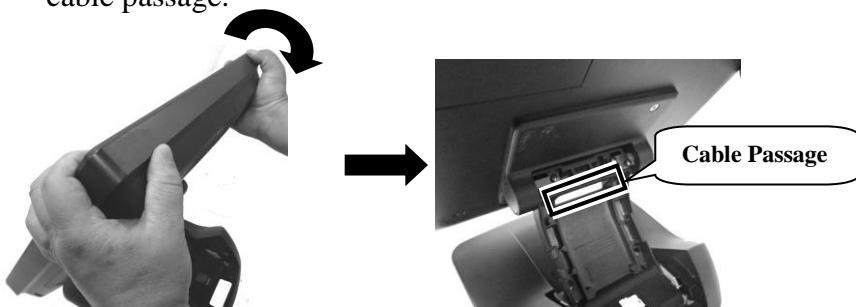

8. Make the connector, which will be connected to the I/O port of the terminal, pass through the cable passage of base stand.

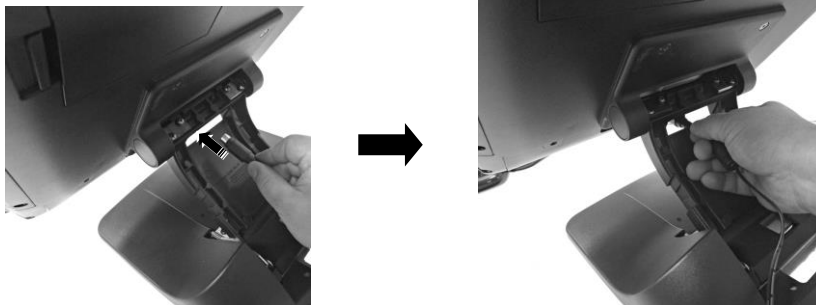

9. Push and tilt the terminal to the end in the direction as shown by the arrow.



10. Remove the bottom I/O cover with your forefinger inserting the middle hole of the cover.



11. Connect the connector of the power adapter to the 12VDC-IN power jack.



12. Cover the bottom I/O interface and gather the I/O cables to the circled cable arrangement area, as shown below.

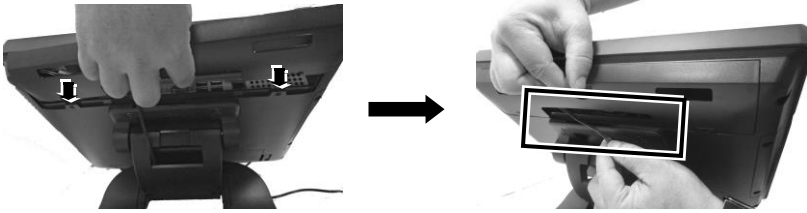

13. Push and tilt the terminal to the end in the direction as shown by the arrow.



14. Arrange well the I/O cable located at the area of neck cover.



15. Shield the I/O cable arrangement area on the neck of the base stand with the neck cover.

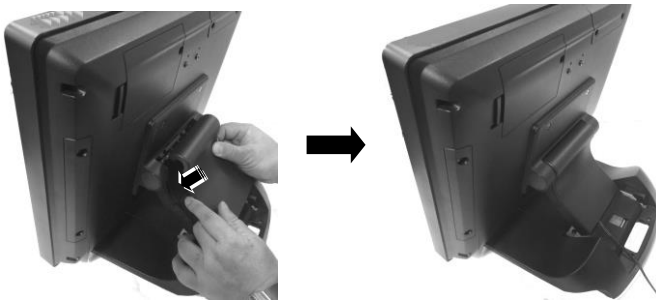

16. Shield the I/O cable exposure area with the cable cover.

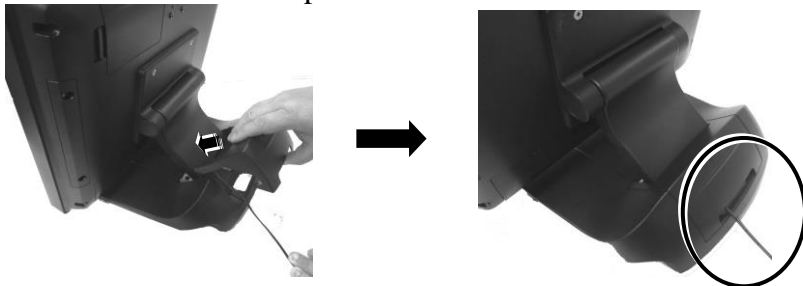

Powering ON the PS-3416/3416E

After connecting the power cable to the power jack of the terminal, press the power button to power on the terminal. To power it off, press the power button again.



Once powering off the system, if you want to power it on again, please wait at least 3 seconds.

If the system hangs due to a reason, such as software resource conflict, please press and hold the power button for over 10 seconds to forcedly shut down the system.

Power LED Indicator

LED status indicator, which is located at the lower right side of the LCD panel, is mainly responsible for notifying users of the current system status by emitting various LED signals. The table provided below shows all the possible LED status as a quick reference.

LED	Status	Description
POWER	Solid blue	System power ON
	Solid orange	System standby

Installing an Operating System

This product is highly professional equipment. Therefore, we do NOT encourage you to install any operating system into this machine without professional assistance. We shall not be responsible for any technical support to questions on this aspect. We suggest that you contact your dealer for OS installation.

Operating System Recovery

For the PS-3416/3416E main system preloaded with an operating system on HDD or SSD, We provide a recovery DVD shipped with the main system for the preloaded operating system. The system integrator shall take care of software restoration after the OS is recovered.

If you plan to recover your operating system, we do NOT encourage you to recover any operating system. Please contact your service center for operating system recovery.

Operation Environment

This terminal must NOT be operated in an environment with restricted ventilation. There must be at least 25 mm air clearance around any top or side ventilation holes with free flow of air around the unit at all times for system operation.

Specifications

System Configuration	Processor	PS-3416: Intel® Celeron J1800, 2C, 2.41GHz/2.58GHz (Burst), 1M Cache PS-3416E: Intel® Celeron J1900, 4C, 2.00GHz/2.42GHz (Burst), 2M Cache
	System Memory	SO-DIMM x 1, DDR3L
	Storage Device	SATA x 1 + mSATA x 1
	Power Supply	12V/40W (upgrade to 60W or higher when required)
	OS support	Windows 7 / POSReady 7 / Windows Embedded 8.1 Industry / Windows 10 IoT 64-bit / DOS / Linux per request
Display & Touch	LCD	Bezel-free TFT LCD
	Resolution	1024 x 768
	Touch	Projected-capacitive touch
I/O & Expansion	Serial Port	4, 3 x DB9 on bottom I/O plate + 1 x RJ50 on top I/O plate, 5V/12V support on all COM ports
	Parallel Port	1, via optional conversion cable
	Standard USB Port	5, 4 on bottom I/O plate + 1 on top I/O plate
	LAN Port	10 / 100 / 1000 Mb x 1
	Display Port	VGA x 1, 12V support for Posiflex monitors
	CR Port	1, control 2 CR via optional Y-cable
	PS/2 Port	Pin header inside service window
	Audio	Buzzer only
	Base Stand	7th generation foldable base stand
	Power Supply	12V/40W
Environmental	Operating Condition	0°C - 40°C, 20%RH - 90%RH (Equipped with HDD); 0°C - 50°C, 20%RH - 90%RH (Equipped with SSD)
	Storage Condition	-20°C - 70°C, 10%RH - 90%RH

※ The product information and specifications are subject to change without prior notice. To get the detailed information on the PS-3416/3416E, please check this model from Posiflex Global Website.

<MEMO>

<MEMO>